



HANOVER HOMES

Guildford Street, Brighton
£1,900 pcm

Two Bedroom City Centre Terraced House

Spacious two bedroom mid terraced Victorian house in an ideal central location with easy access to Brighton Mainline Station.

The apartment comprises; a spacious living dining room, a modern fitted kitchen with fridge freezer, oven and gas hob, and space and plumbing for a dishwasher. There is a handy utility area with washing machine and space for a tumble dryer. From here doors lead out to a small patio area.

Upstairs there are two good sized double bedrooms and a very spacious bathroom with a shower over the bath.

Early viewing is highly recommended.

Council Tax Band: C

Deposit: £2,192.3

Holding Deposit: £400

More details can be found at www.hanoverhomes.net or scan below:





Whilst every effort is made to ensure the accuracy of these details, it should be noted that the measurements are approximate only. Floorplans are for representation purposes only and prepared according to the RICS Code of Measuring Practice by our floorplan provider. Therefore, the layout of doors, windows and rooms are approximate and should be regarded as such by any prospective tenant.

Ground Floor

Approx. 40.7 sq. metres (438.4 sq. feet)

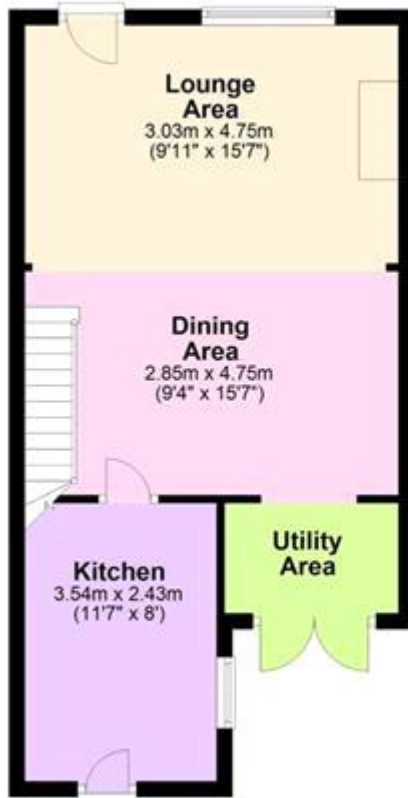

First Floor

Approx. 39.3 sq. metres (422.5 sq. feet)



Total area: approx. 80.0 sq. metres (860.9 sq. feet)



Energy Efficiency Rating		
	Current	Potential
Very energy efficient - lower running costs		
(92-100) A		
(81-91) B		
(69-80) C		
(55-68) D	62	
(39-54) E		
(21-38) F		
(1-20) G		
Not energy efficient - higher running costs		
England & Wales	EU Directive 2002/91/EC	

The energy efficiency rating is a measure of the overall efficiency of a home. The higher the rating the more energy efficient the home is and the lower the fuel bills will be.



HANOVER HOMES

Viewing by appointment only
Hanover Homes

73 Southover Street, Brighton, East Sussex BN2 9UF

Tel: 01273 692233 Email: hello@hanoverhomes.net Website: www.hanoverhomes.net/